

Saint John Paul II Parish

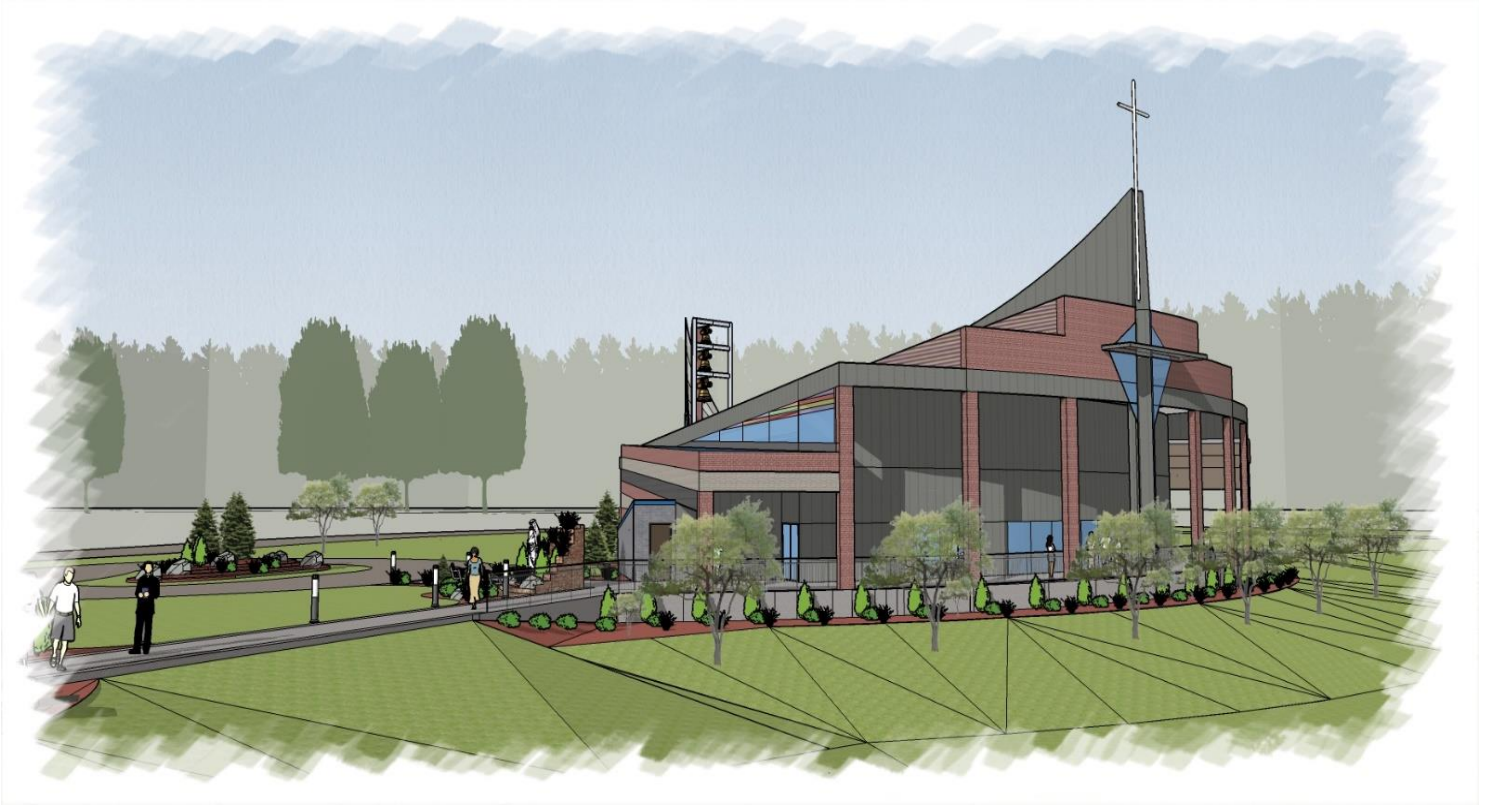

Growing in God's Merciful Love

Case for Support

July 2016

*A campaign to continue becoming
His hands and His feet in our community*

*“United in Christ through the Sacrament of the Eucharist,
the welcoming parish of St. John Paul II is to become His hands and feet:
His hands by reaching out and serving one another and
His feet by journeying together on the narrow path of our faith that leads us closer to Christ.”*

The Call

Two and a half short years ago we celebrated our first Mass on July 6, 2013. Since that day, Saint John Paul II Parish (JP II) has been a growing family of believers. We opened with 60 family households. Today, more than 300 families call JP II home, and that only includes those who have officially registered. Our four weekend masses are all well-attended and some exceed capacity.

We always knew we were destined to grow. Our 13 acres were purchased with the full intent of one day fulfilling our vision to grow our Catholic community in Cedar Springs so much that we would need to build a new, larger church. The response to Saint John Paul II Parish has surpassed all projections. Growth has come quickly. As a result, we are already feeling the constraints of the current space.

The Need

God has blessed us with this growing, vibrant parish family. Every year more people respond to God’s love through our church and programs. Since opening, we have brought 60 new people to the Church and our Catholic faith, more so than any other church in the Diocese!

	2013 (July-Dec.)	2015 (Jan.-Oct.)	2018 Projected
Parish Families	60	300	600
Baptisms	8	60	80
First Communion	6	30	60
Religious Ed. K-8th	0	110	225

Additionally, our area continues to grow, drawing new families to our community, and the possibility for additional parishioners. From 2009-2015, Cedar Springs experienced an 18% increase in population. It is projected that the townships of Algoma, Nelson and Solon will increase another 13-15% between 2015-2020.

However, with any growth comes challenges, as well as opportunities. We have already started implementing some components of our Master Plan to begin addressing the increasing needs of our current parishioners.

We recently:

- Renovated and upgraded our kitchen to continue our outreach ministry, and for our own internal use for social programs, etc.
- Renovated our lounge
- Added space for ministry and faith formation programs

All of this is good. But the most important work we do as a family of Christ followers is nourishing our current members, and welcoming new people into relationship with Jesus. Right now we are challenged to do that.

Although our current church is not very old, we are already crowded in the pews. Our masses are full. Families are often challenged to find a place to sit together. Parishioners sometimes are forced to sit in the narthex. And some masses are so full that people simply leave upon realizing there is no space for them. Sadly, we are turning people away.

We've done great things to draw people to us. But we must do something to take care of those who are already coming, as well as continue to ensure we have the space to invite new families to JPII. We have some challenges. But we have a plan to address those challenges moving forward.



The Plan

Part of our Master Plan includes a new church. We now have a schematic design of our new worship space. The church will be built to meet our immediate and near-future needs. But the church will be *designed* for our projected long-term growth. This will enable us to add on when, and as needed, in phases over time. We've planned according to our anticipated growth, but would only implement when these projections became a looming reality.

The new church will allow us to address our most pressing need today: **more worship space to better care for our current parishioners, and welcome new people to Jesus.**

Our current church is approximately 2,300 square feet and is designed to seat 150 parishioners per mass comfortably. To accommodate attendance, we have been squeezing in nearly 190 for most masses. This first phase in the new church plan will be 5,100 square feet and will accommodate 312 people comfortably. That is an additional 122 people per mass! It will also have flexibility for peak times such as Holydays, weddings, funerals and other special occasions, giving us 75 more seats for a total of nearly 400 per mass. This number is based on our current growth rate to date which we then projected out.

The new church will also be more accessible including a new sound system with a hearing loop, have a larger narthex to meet and greet, and a covered portico for comfort and safety when arriving and departing church as well as for gatherings outside. We are also discussing the possibility of a basement, but nothing has yet been determined.

We have focused our attention on the interior to ensure that it is worshipful, prayerful and supportive of bringing families closer to one another and to God. The exterior will come next.



Current Church:
2,300 square feet
Holds 190 parishioners

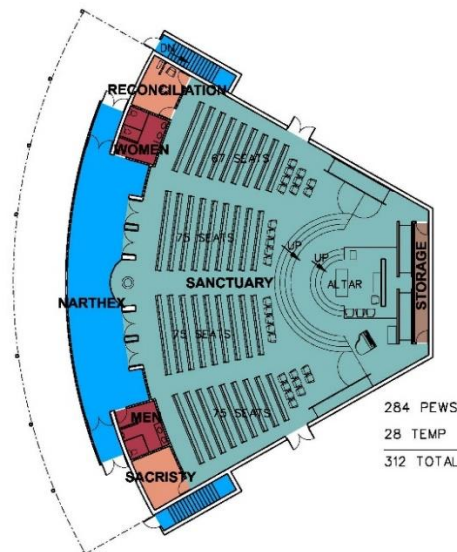

New Church Interior
5,100 square feet
Holds more than 300 parishioners
Includes flex space to add another 75 seats

Additionally, the plan will include a rectory on campus that will give us the structure to grow, protect and nurture our sacramental ministries. Our church growth will ultimately demand more from our pastor. Optimally, we would desire to grow our religious staff to assist. With a rectory, we could:

- provide a home for our priest, making him more readily available for parishioners
- invite and encourage retired, visiting priests or seminarians to come, stay and participate in our church life
- have space for an associate pastor potentially when our growth reaches that level

When needed in the future, the church and campus will be able to accommodate our long-term growth because of the design decisions we are making today. Future phases include:

- Seating up to 600 people
- Expanding our narthex for larger social gatherings
- Adding a cry room and more classroom space
- Enlarging the parking lot and adding a protected drop off/pick up location

But first and foremost we must have room in our pews for our existing parishioners and any newcomers. This is where we meet God, celebrate His word, share in the holy sacrament of Eucharist and enjoy fellowship with our brothers and sisters in Christ. Having a place for everybody who wishes to come is our number one goal.

It is important to note that our current structure will continue to be used for ministry and outreach programs even after the new church is built. The recent renovations and improvements we have made will continue to serve us well in the future.

The Architectural Schematic

The architectural schematic design is helpful, but it is not everything. It allows us to see where the church and rectory will be located on campus and the basic layouts. It provides enough detail to ensure we are on the same page and helps us form our fundraising plan.

However, fine details such as materials to be used, windows, paint colors, pews, etc. will be determined at a later date. We will keep everyone apprised of our progress, and invite discussion at decision-making times. Parishioners will continue to have a voice in this process and be able to offer comments and remarks at the appropriate time. This is *your* church we are building and we want and need you to have a say in its final design.

COST AND FUNDING

Being good stewards of our resources, we will only begin construction once half of the funds have been raised. We are planning a fundraising campaign that would begin sometime in 2016. People will be asked to financially support this project with a prayerfully considered pledge that would be payable over three years.

It is our hope and prayer that we would have the necessary funds secured (at least half) and have our detail construction drawings finalized to begin construction in 2018.

While we are still working through exact details of the project, below is an estimated outline of expenses and where we would find the revenue to support them.

ESTIMATED COSTS

Finished main floor new church.....	\$1,787,000
Unfinished Lower level.....	476,000
Rectory.....	<u>200,000</u>
Sub-total new construction.....	\$2,463,000
Sitework allowance.....	\$600,000
Furnishings allowance.....	,226,000
Fees.....	300,000
Contingency.....	<u>411,000</u>
Sub-total Other.....	\$1,537,000
TOTAL Estimated Cost.....	\$4,000,000

APPROXIMATE FUNDING

Parish-wide capital campaign.....	\$1,000,000
Other (outside parish support).....	\$1,000,000
Low interest loan from Diocese.....	\$2,000,000

The Response

The heart of a church is where God and humanity are united, and where faith is nourished, strengthened and handed over to future generations. Saint John Paul II Parish has developed a bold vision to build a stronger Catholic presence in the area that will serve the current parishioners and future generations to come.

Achieving our goal will require all of us to give sacrificially, over and above our current giving for a 3-year period. We are all blessed differently, so sacrifice means something different to everyone. For some, it may mean eliminating some current expenditure to increase giving. Others will delay a major expenditure. Some will give special gifts such as stocks and bonds.

What each of us eventually gives is an individual response to a theme of “not equal gifts, but equal sacrifice.”

Early Catholics who settled in the greater Grand Rapids area sacrificed so that there would be a church in which to worship, to receive sacraments and to grow in faith. Today, we are being called in a similar way to ensure that there is a holy place dedicated to meeting the growing, thriving, living Catholic faith found here in Cedar Springs.

**God is calling.
Will you respond?**

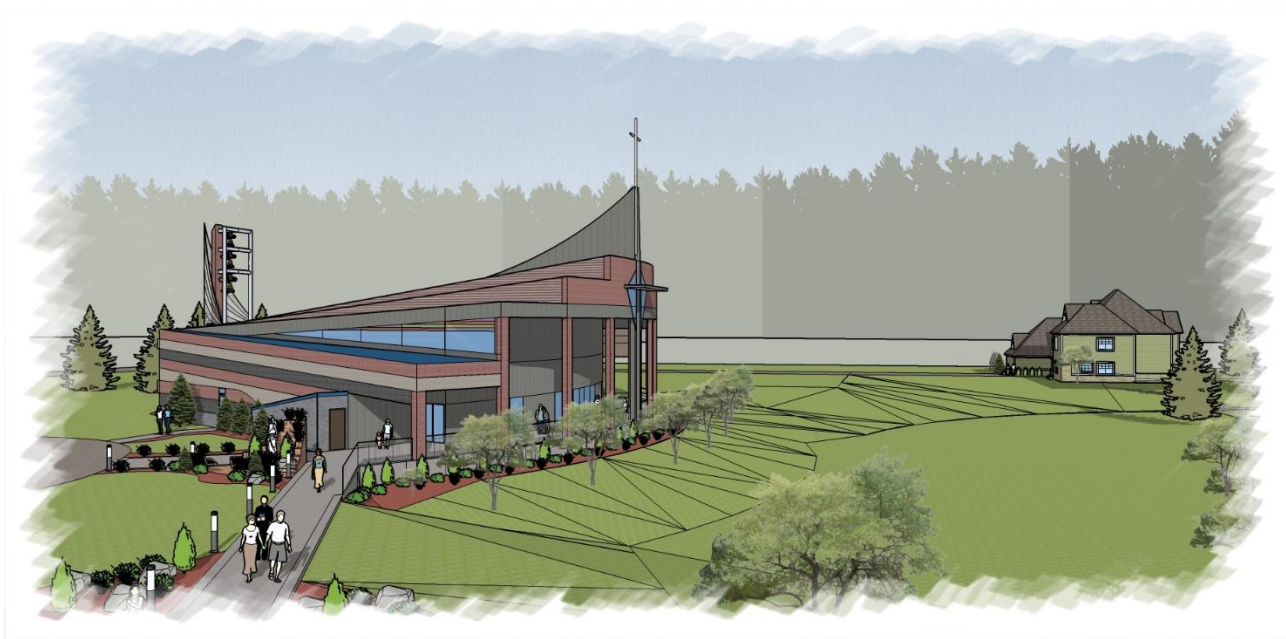

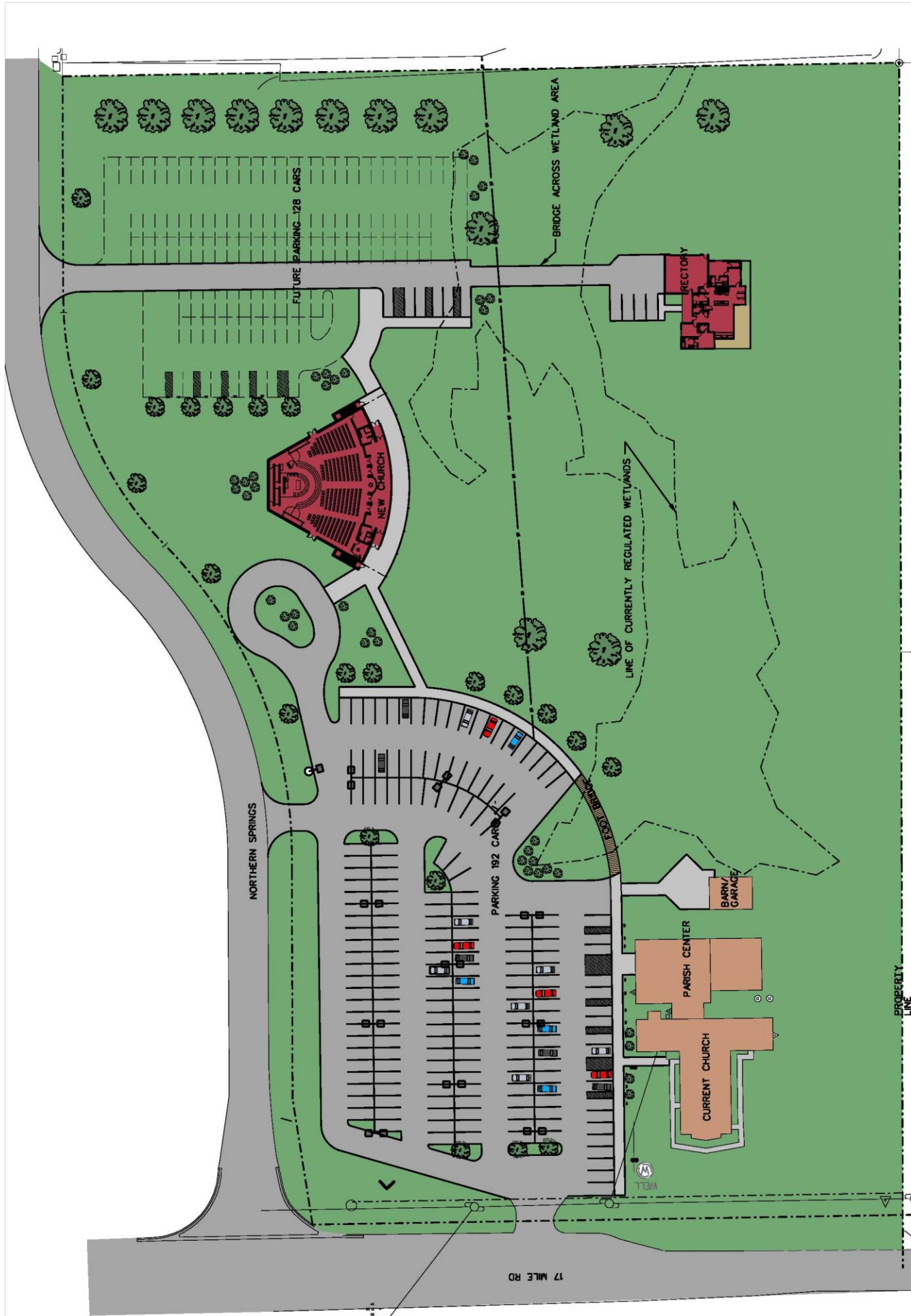

NORTHERN SPRINGS

FUTURE PARKING...128 CARS

NEW CHURCH

PARKING 192 CARS

BRIDGE ACROSS WETLAND AREA

LINE OF CURRENTLY REGULATED WETLANDS

PARISH CENTER

BARN/GARAGE

RECTORY

CURRENT CHURCH

WELL

17 MILE RD

PROPERTY LINE