

CONTINUING

THE JOURNEY.

I/we would like to make a new pledge/additional gift so we can soon achieve our \$1 Million Parish Goal.

My/our financial commitment will be:

- Pledge
- Pledge w/ initial payment
- One-time gift
- Securities
- Other (please explain) _____

Name: _____
Phone: _____



Return this card to the Church Office or place in the Offeratory Basket.



Special Edition Campaign Newsletter

March 2018

Keep Our Vision Growing in God's Merciful Love
Capital Stewardship Campaign Newsletter

God is Calling. How Will You Respond?

Dear Parishioners and Friends of Saint John Paul II Parish,
From the moment we celebrated our first mass at Saint John Paul II Parish, we have seen tremendous growth. In fact, we have six times more families today than we had back then. However, our current worship space has not grown to reflect the size of our Parish.

We have exercised due diligence in planning for a new, larger church. We began by creating a parish master plan in 2015, which was developed with input from parishioners, as well as an architect. The master plan is designed to maximize the coordination and utilization of our facilities and property. In order to be the best stewards of our resources, the parish also underwent a feasibility study in 2016. The purpose of the feasibility study was to assess the parish's capacity to raise the funds needed for the church. The study included a survey of all parishioners and personal interviews. The results of the study were very favorable and indicated that our parish has the capacity and willingness to raise the funds needed for the new church! Both of these efforts led us to launch our capital campaign, "Growing in God's Merciful Love".

The first phase of the capital campaign was a success and led us into the second phase, "Keep our Vision Growing in God's Merciful Love". So far, we have received \$750,000 in pledges. While we work towards our \$1 million capital campaign goal, Bishop Walkowiak has offered us assistance from the Diocesan Savings and Loan Fund to allow us to accelerate our timeline. This is not a gift, but a loan that we will be repaying. With this loan, we are able to break ground this year. However, we want to challenge our parishioners to pledge the remaining amount prior to the groundbreaking!

With the Bishop's blessing, we have been working with AMDG Architects to design the new church and rectory. AMDG held a workshop with parishioners in October to inform the design and they recently presented the renderings to the Parish. Those in attendance were asked to rate the design and it received unanimously high marks. Enclosed in this newsletter, you will see the exciting new renderings of the interior and exterior of the church. This is not a final design, but will be fine-tuned as we continue preparing to break ground. We expect to present a final design and updated project timeline in the coming months.

The work we are doing now will impact our Parish and community for years to come, as well as offer a more comfortable and welcoming place for our friends, families, and parishioners. We hope you share our enthusiasm and look forward with anticipation to breaking ground on our new church!

Sincerely,

Rev. Lam T. Le
Pastor

Jim Pope
Finance Council Chair

Mindy Larva/Chris Pigorsh
Campaign Co-Chairs

Chris Bade
Building and Grounds Chair



HOW CAN I HELP?

Because each of us is blessed differently and capable of different gifts, we are each asked to financially support this campaign accordingly. What you give should be over and above your regular giving.

No one will tell you what to give toward this campaign—that is between you and the Lord. "Growing in God's Merciful Love" only asks that you pray and make a sacrificial gift according to how you've been blessed and act as the Lord leads. We are calling upon those that haven't yet given to prayerfully consider what a sacrificial gift would be for them. We are also calling on those that have given to reflect on whether their gift has been a sacrifice. A new church that meets our needs is our goal, and Christ is our reason and example.

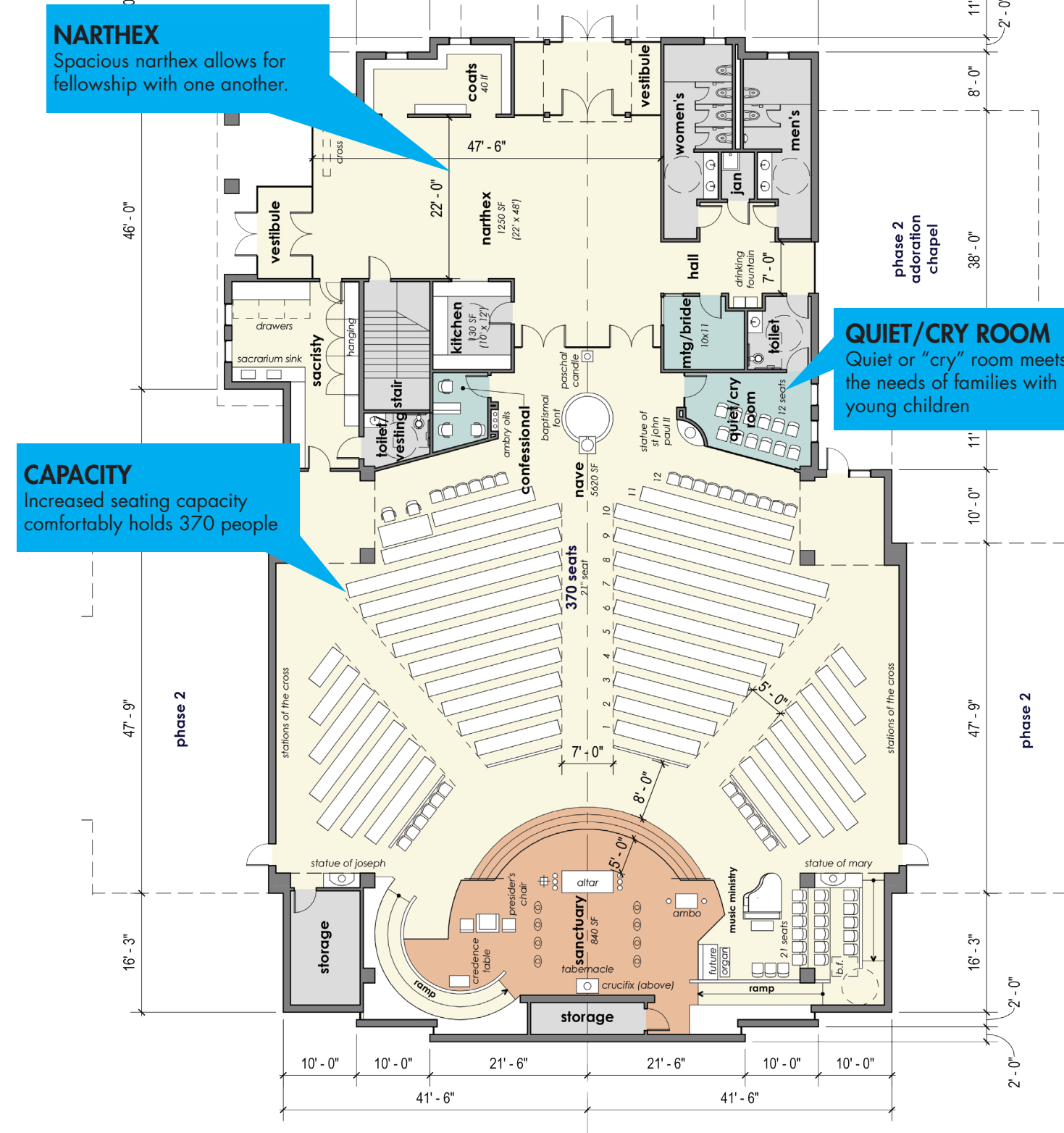

The New Church Design

AMDG
ARCHITECTS
with | Erhardt Construction

The New Church Design