

GROWING IN GOD'S MERCIFUL LOVE

SAINT
JOHN
PAUL II
PARISH
Cedar Springs, MI



Capital Stewardship Campaign

October 2016

Count Your Blessings

Rev. Lam T. Le

The heart of the parish is the church where God and humanity are united, where faith is nourished, strengthened, and handed to other generations. It is a sacred place where Mass is celebrated, sacraments are received, prayer and song rise to praise God, and ministry programs respond to God's command to love and touch the lives of parishioners and community.

As parishioners, we collectively make up the Body of Christ. The well-being of this body is the personal responsibility of each parishioner. Christ's blessings come through our actions of sacrifice and giving to others. Our personal service is but one aspect of this giving - our financial gifts are another. As followers of Christ, we are to use our gifts to further His work.



As we commit ourselves to Christ through service, prayer, and the "Growing In God's Merciful Love" capital stewardship campaign, I want you to reflect on the blessings of God in your life and in the life of this parish. Our eyes should be opened to the many blessings that God has given to us. We find blessings through our family, friends, parish, our special talents and abilities, and in the opportunities to share Christ and serve others. These blessings will always outweigh the material possessions that surround us.

The ultimate challenge to our parish community, whether you have been a member since we opened or a member since last month, is for each household to give sacrificially. Supporting St. John Paul II Parish should be a priority in your life. It will require everyone to review spending priorities and to make a sacrificial pledge, "over and above" your regular offertory, that changes the way you live for three years.

Remember October 29/30 weekend is Commitment Weekend. During each of the weekend masses, parishioners will be provided a commitment card. The weekend begins the pledge phase of our campaign where each of us should begin confidentially registering a 3-year pledge by completing a commitment card. I am counting on each and every parishioner to do their part in making this campaign a success. As you consider your 3-year sacrificial pledge to the Growing In God's Merciful Love capital stewardship campaign and to Christ's work here at St. John Paul II Parish, count your blessings and give accordingly as He leads you.

Rev. Lam T. Le

St. John Paul II Parish
3110 17 Mile Rd.
Cedar Springs, MI 49319

GROWING IN GOD'S MERCIFUL LOVE

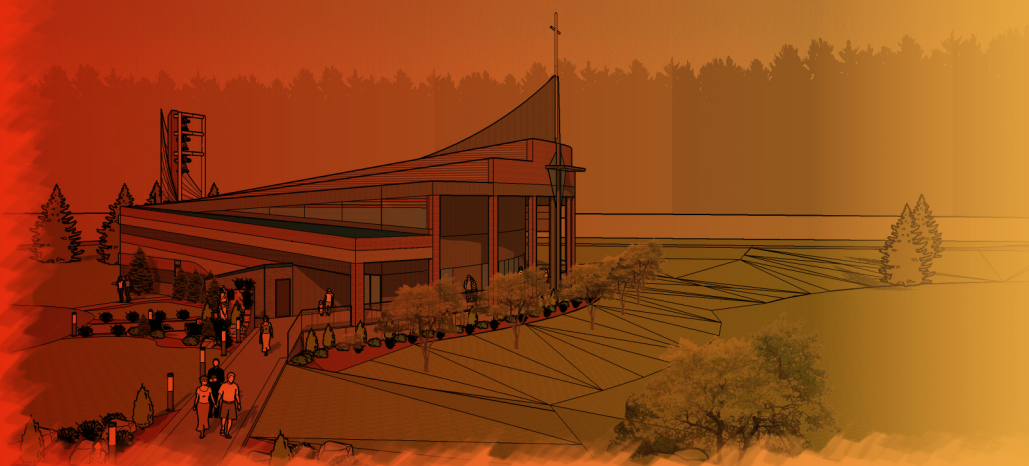

SAINT
JOHN
PAUL II
PARISH

Cedar Springs, MI

Excitement is Building!

You are invited to join us at a reception following the **10:30am** mass on **Sunday, October 30**. Come celebrate the start of the commitment phase and enjoy fellowship with parishioners.

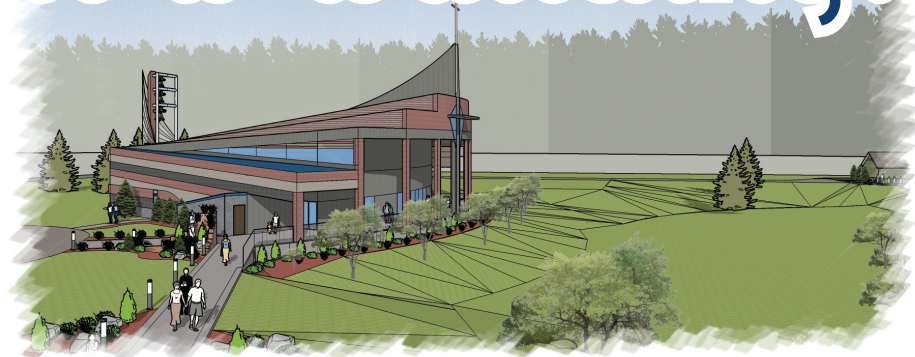

WHAT IS YOUR PIECE OF THE PUZZLE?

WE ARE ALL PARTS OF THE BODY AND EACH OF US IS BLESSED DIFFERENTLY. EACH OF US IS A PART OF THE PUZZLE OF THE MINISTRY OF THIS FAITH COMMUNITY. IF ANY PIECE IS MISSING, THE PICTURE WON'T BE COMPLETE. AS FAITHFUL STEWARDS, WE MUST COMMUNICATE WITH GOD THROUGH PRAYER AND LISTEN TO WHAT HE WOULD HAVE US DO IN HIS NAME.

AS YOU CONSIDER YOUR 3-YEAR COMMITMENT TO OUR GROWING IN GOD'S MERCIFUL LOVE CAMPAIGN, CONSIDER THE MANY GIFTS GOD HAS GIVEN YOU AND PRAY FOR HIS GUIDANCE IN YOUR LIFE AND THE LIFE OF THIS FAITH COMMUNITY. MAY THE PEACE OF GOD BE WITH EACH OF US AS WE SEEK AND DO HIS WILL.

Giving Worksheet

Cash Gifts \$ _____

\$ _____ weekly x 156 weeks = \$ _____

\$ _____ monthly x 36 months = \$ _____

\$ _____ quarterly x 12 quarters = \$ _____

Additional Work Income.....\$ _____

Matching Gifts Offered by an Employer\$ _____

Stocks & Bonds\$ _____

Non-cash\$ _____

Antiques/Collectibles.....\$ _____

IRA.....\$ _____

Other.....\$ _____

Other.....\$ _____

Other.....\$ _____

Possible 3-year TOTAL \$ _____

CASH GIFTS AREN'T THE ONLY OPTION YOU HAVE FOR GIVING TO THE CAMPAIGN!

- Stocks
- Bonds
- IRA Charitable Donation
- Life Insurance Policies
- Vehicles
- Dwellings
- Land
- Jewelry
- Antiques
- Collectibles
- Other personal properties

Get Committed to Our Capital Campaign

The commitment card used in our capital campaign is not a contract, but a simple statement of intent. Knowing expected dollar amounts (intention) is very important in our planning.

You will receive a commitment card at mass on Commitment Weekend (October 29/30), along with a privacy envelope, and be asked to confidentially complete and return it in the following couple of weeks.

You can also include any non-cash gifts, such as stock, bonds, real estate, etc., to enhance your cash gifts. When you complete your commitment card, record any non-cash gifts and their estimated value. Remember, your commitment should be over and above your regular/annual offertory giving.

Growing in God's Merciful Love Pledge Card

Thankful for God's blessings and recognizing that all I/we possess is a gift from God, I/we respond with faith to our "Growing in God's Merciful Love" campaign.

Name: _____ Phone: _____ Address: _____

YES! I/we would like to support Growing in God's Merciful Love. My/our financial commitment will be: Pledge Pledge w/ initial payment

One-time gift Securities Other (please explain) _____

\$ _____ - \$ _____ = \$ _____

(total pledge) (initial payment) (balance)

My/our pledge balance will be paid in equal installments beginning ___/___ (month/year) and ending ___/___ (month/year).

Frequency: Annually Quarterly Monthly Weekly Other (please explain) _____

Method: Check/cash Electronic Funds Transfer Stocks/Bonds ACH/auto-withdrawal (church office will provide form) Online giving

Authorized Signature: _____ Date: _____

I/we understand this is a statement of intent and may be altered as circumstances warrant.

Please send me/us information about gifts of stock and securities. This pledge is in honor of: _____

I/we have enclosed an employer matching gift form. This pledge is in memory of: _____

I/we cannot pledge right now, but will do what I can & pray for the campaign

Please make checks payable to: St. John Paul II - Growing in God's Merciful Love. **THANK YOU** for your pledge!

WHERE ON THE CHART IS A "SACRIFICE" FOR YOU?

The following chart illustrates the types of three-year pledges (over and above regular giving) needed to reach our \$1 million financial goal. Everyone in our parish family is needed!

Gifts Needed	Total Gift	Optional 10% Initial Payment	Remaining Balance	Payment Options			Cumulative Total
				Monthly(36)	Quarterly(12)	Annually(3)	
Tier 1							
2	\$50,000	\$5,000	\$45,000	\$1,250	\$3,750	\$15,000	\$100,000
4	25,000	2,500	22,500	625	1,875	7,500	200,000
8	15,000	1,500	13,500	375	1,125	4,500	320,000
10	10,000	1,000	9,000	250	750	3,000	420,000
Tier 2							
20	\$8,000	\$800	\$7,200	\$200	\$600	\$2,400	\$580,000
20	6,000	600	5,400	150	450	1,800	700,000
25	4,000	400	3,600	100	300	1,200	800,000
20	3,000	300	2,700	75	225	900	860,000
Tier 3							
35	\$2,000	\$200	\$1,800	\$50	\$150	\$600	\$930,000
40	1,000	100	900	25	75	300	970,000
30	750	75	675	19	56	225	992,500
Remainder	\$500 or less	\$50 or less	\$450 or less	\$13 or less	\$38 or less	\$150 or less	\$1,000,000